

FW 50+ SG: Yapısal camlama

Schüco FW 50⁺ SG ve FW 60⁺ SG yapısal camlama sistemleri görsel açıdan etkileyici tamamı cam cepheler inşa etmede kullanılabılır. Sadece oda tarafından görülebilen profiller kullanılmasıyla ince hatlı gölge fugalara sahip aynı seviyede bir cephe görünümü, büyük ve küçük çapta konstrüksiyon projelerine yönelik uyumlu bir mimari yapı oluşturacak şekilde elde edilebilir. Diğer bir artısı da iç ve dış bölme kalınlıklarına dair kapsamlı kombinasyon seçeneklerinin mevcut olmasıdır.

Schüco FW 50⁺ SG ve FW 60⁺ SG denenmiş ve test edilmiş Schüco FW 50⁺ / FW 60⁺ düşey profil-yatay profil sistemlerinin kapsamlı yelpazede yük taşıyıcı yapılarını esas alır.



Özellikler ve yararlar

- 375 kg'ye kadar olan cam ağırlıkları için yapısal cam cephe (FW 50⁺ SG) veya sabit pencereler için 450 kg'ye kadar olan cam ağırlıkları (FW 60⁺ SG)
- hava sızdırmaz köşe contası için 2 parçadan oluşan paslanmaz çelikten ara halkalar
- Aynı seviyeye monteli veya U şekilli silikonlu kuru conta veya nemli sızdırmazlık mümkündür
- İç ve dış bölmelerin cam kalınlıkları için genişletilmiş kombinasyon seçenekleri (6 ile 14 mm arasında)
- Schüco AWS 102 veya Schüco AWS 102.NI açma üniteleri paralel açılan pencereler veya düşmeli ters vasistaslı pencereler olarak kullanılabilir.
- Açma ünitesi ile 250 kg'ye kadar kanat ağırlıkları için yeni donanım nesli
- ETAG 002 ile uyumlu olarak onaylanmıştır

Tech. Information

Material	
Aluminium	
Type of construction	
Thermally insulated	
Façades	
Curtain walling	
Structural glazing	
Further tests	
Air permeability DIN EN 12152	AE
Weathertightness DIN EN 12154	RE ₁₀₅₀
Measurement of sound insulation DIN EN 20140	

CAD-Drawings

Schüco AWS 102.NI

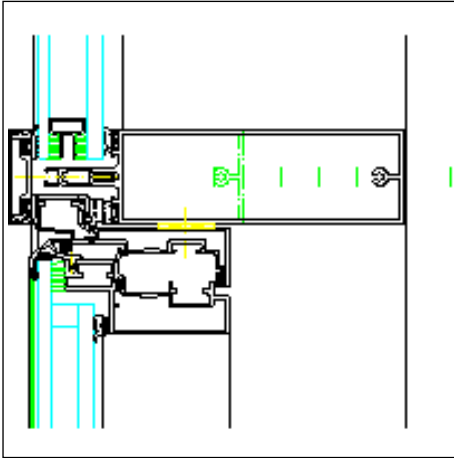

Mullion and transom sections
Horizontal cover cap with retaining frame

Drawing dxf (dxf/223 KB)
 Drawing dwg (dwg/87 KB)

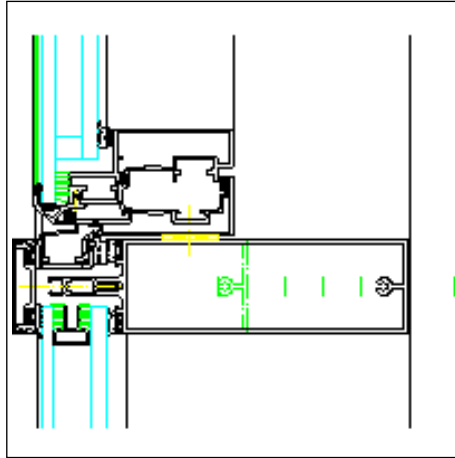

Mullion and transom sections
Horizontal cover cap with retaining frame

Drawing dxf (dxf/223 KB)
 Drawing dwg (dwg/87 KB)

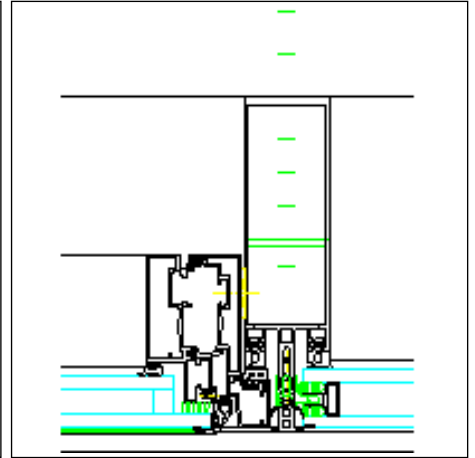

Mullion and transom sections
Horizontal cover cap with retaining frame

Drawing dxf (dxf/234 KB)
 Drawing dwg (dwg/86 KB)

Schüco AWS 102

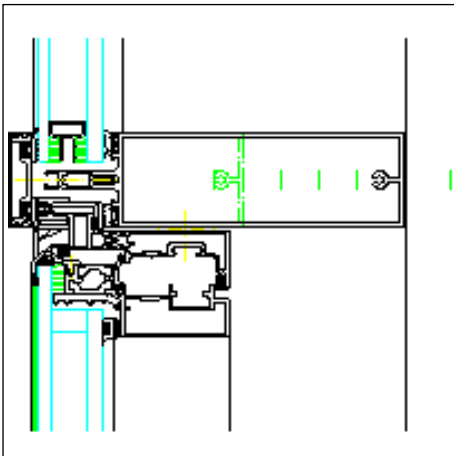

Mullion and transom sections
Horizontal cover cap with retaining frame

Drawing dxf (dxf/239 KB)
 Drawing dwg (dwg/79 KB)

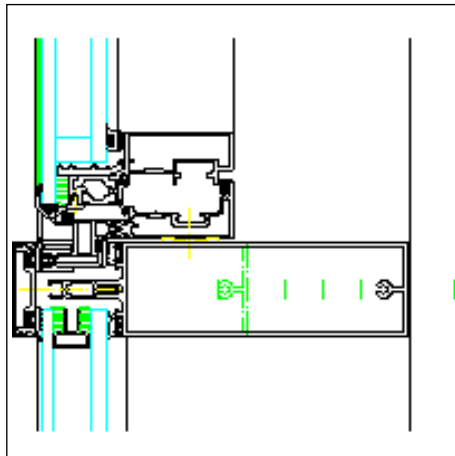

Mullion and transom sections
Horizontal cover cap with retaining frame

Drawing dxf (dxf/237 KB)
 Drawing dwg (dwg/78 KB)

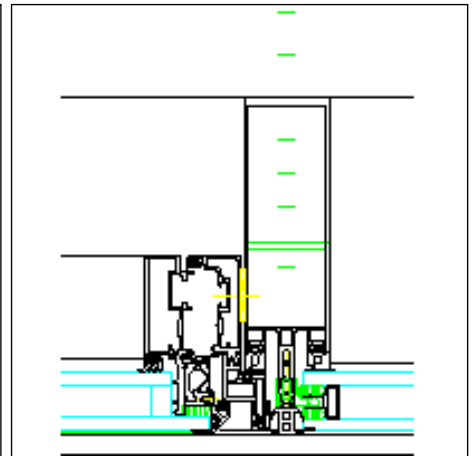

Mullion and transom sections
Horizontal cover cap with retaining frame

Drawing dxf (dxf/251 KB)
 Drawing dwg (dwg/94 KB)

Schüco AWS 102.NI

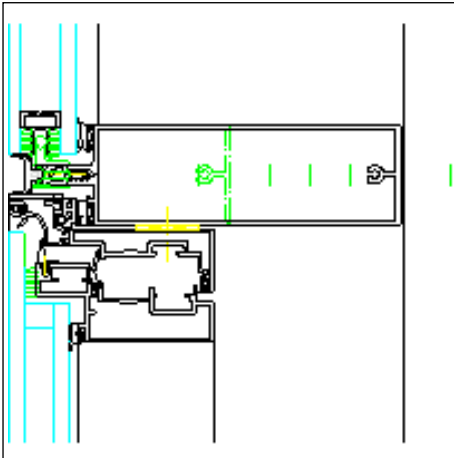

Mullion and transom sections
Structural glazing on 4 sides

Drawing dxf (dxf/247 KB)

Drawing dwg (dwg/93 KB)

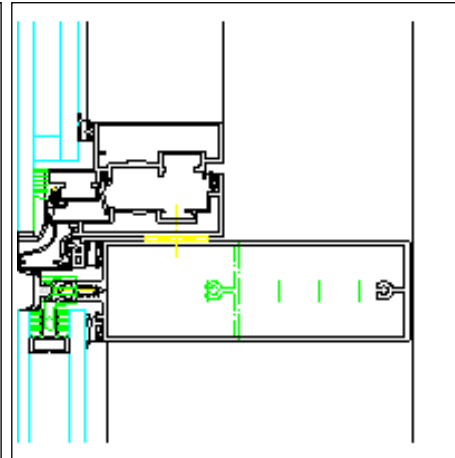

Mullion and transom sections
Structural glazing on 4 sides

Drawing dxf (dxf/247 KB)

Drawing dwg (dwg/93 KB)

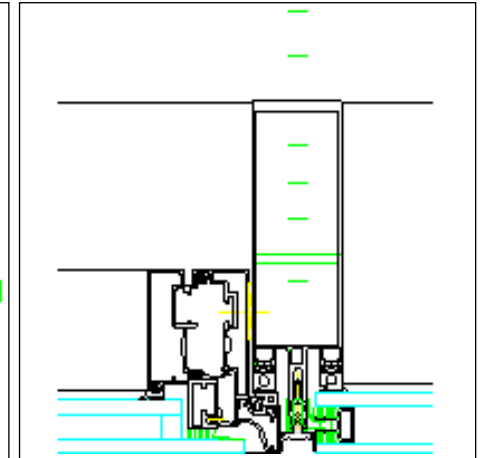

Mullion and transom sections
Structural glazing on 4 sides

Drawing dxf (dxf/225 KB)

Drawing dwg (dwg/87 KB)

Schüco AWS 102

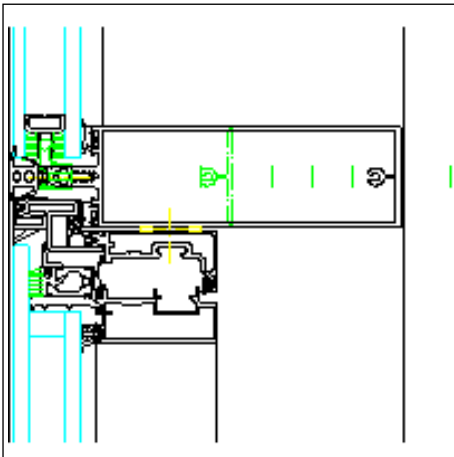

Mullion and transom sections
Structural glazing on 4 sides

Drawing dxf (dxf/250 KB)

Drawing dwg (dwg/79 KB)

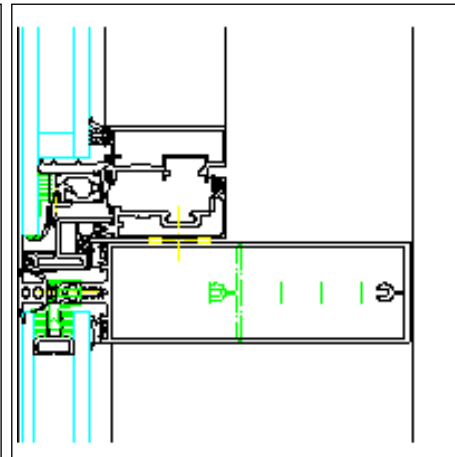

Mullion and transom sections
Structural glazing on 4 sides

Drawing dxf (dxf/268 KB)

Drawing dwg (dwg/82 KB)

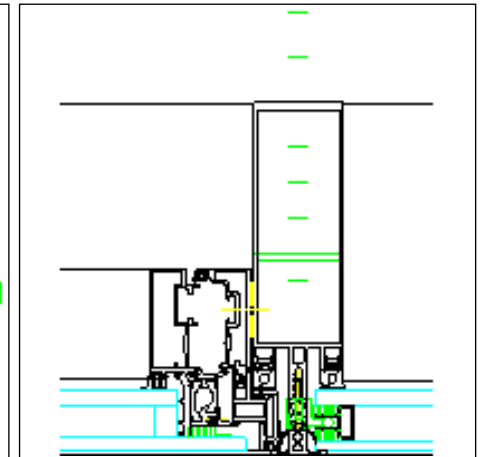

Mullion and transom sections
Structural glazing on 4 sides

Drawing dxf (dxf/249 KB)

Drawing dwg (dwg/77 KB)

Mullion/transom 1

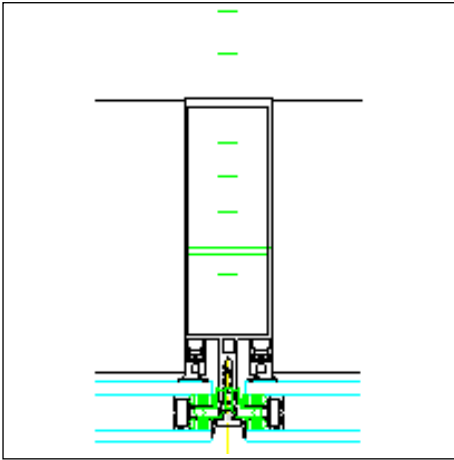

Silicone joint mullion with U-shaped dry glazing

Drawing dxf (dxf/101 KB)

Drawing dwg (dwg/51 KB)

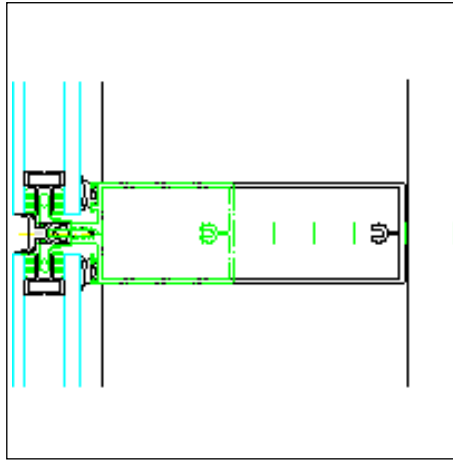

Silicone joint transom with U-shaped dry glazing

Drawing dxf (dxf/99 KB)

Drawing dwg (dwg/50 KB)

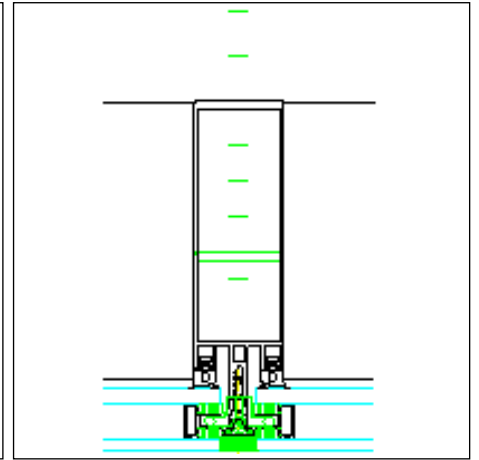

Silicone joint mullion wet sealing

Drawing dxf (dxf/95 KB)

Drawing dwg (dwg/51 KB)

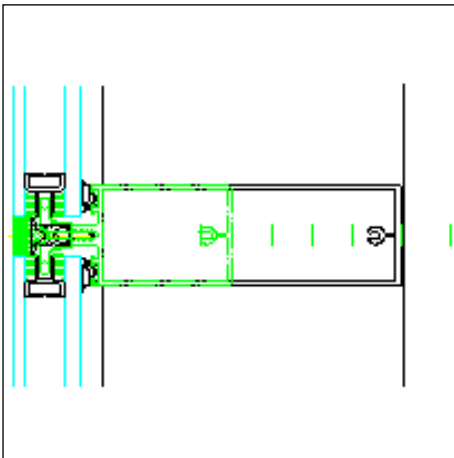

Silicone joint transom wet sealing

Drawing dxf (dxf/83 KB)

Drawing dwg (dwg/46 KB)

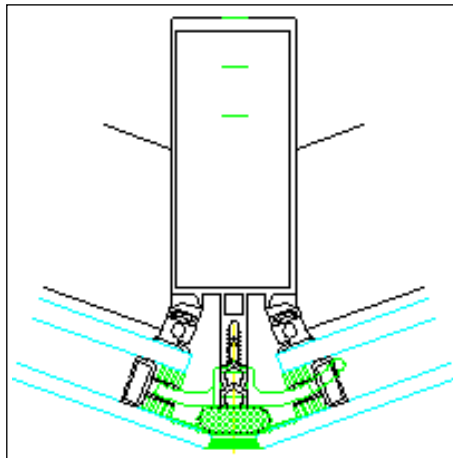

Mullion Variable outer corner (90°-170°)

Drawing dxf (dxf/106 KB)

Drawing dwg (dwg/49 KB)

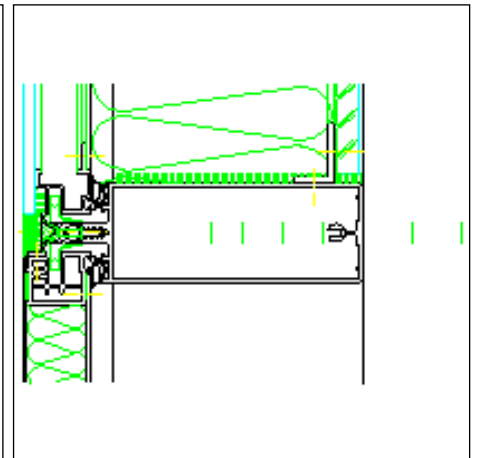

Spandrel panels transom section detail

Drawing dxf (dxf/118 KB)

Drawing dwg (dwg/55 KB)